

Lexan Thermoclick applications in detail



Ampelite Australia Pty Ltd
ABN 91 487 122 629

VIC & TAS	Tel 03 8710 9110	Fax 03 9794 0710	NSW & ACT	Tel 02 9625 7200	Fax 02 9625 7211
QLD	Tel 07 3382 8300	Fax 07 3200 8703	Nth QLD	Tel 07 4774 5007	Fax 07 4774 7898
SA & NT	Tel 08 8260 7391	Fax 08 8260 7397	WA	Tel 08 9302 6833	Fax 08 9302 6855
NZ	Tel 09 634 5366	Fax 09 622 2060			

www.ampelite.com.au



Quality
Endorsed
Company
AS/NZS ISO 9001
QEC 4787
SAI GLOBAL

Ampelite Lexan Thermoclick

The Lexan Thermoclick is a uniquely engineered thermoplastic product combining exceptional levels of mechanical, optical and thermal properties. Lexan Thermoclick sheet LTC404X4000, is an impact resistant, energy saving multi-wall sheet with a profiled tongue and groove connection. This inter-connecting system eliminates the need for vertical profiles, thereby saving costs and enhancing aesthetics.

The sheeting is 40mm thick, having an effective cover of 500mm and maximum length of 11.8m. Both clear and opal colours are stocked locally and all accessories are produced in Australia. The sheeting has a one side UV protection requiring this side to always remain facing outward.

The Lexan Thermoclick sheet profile is:

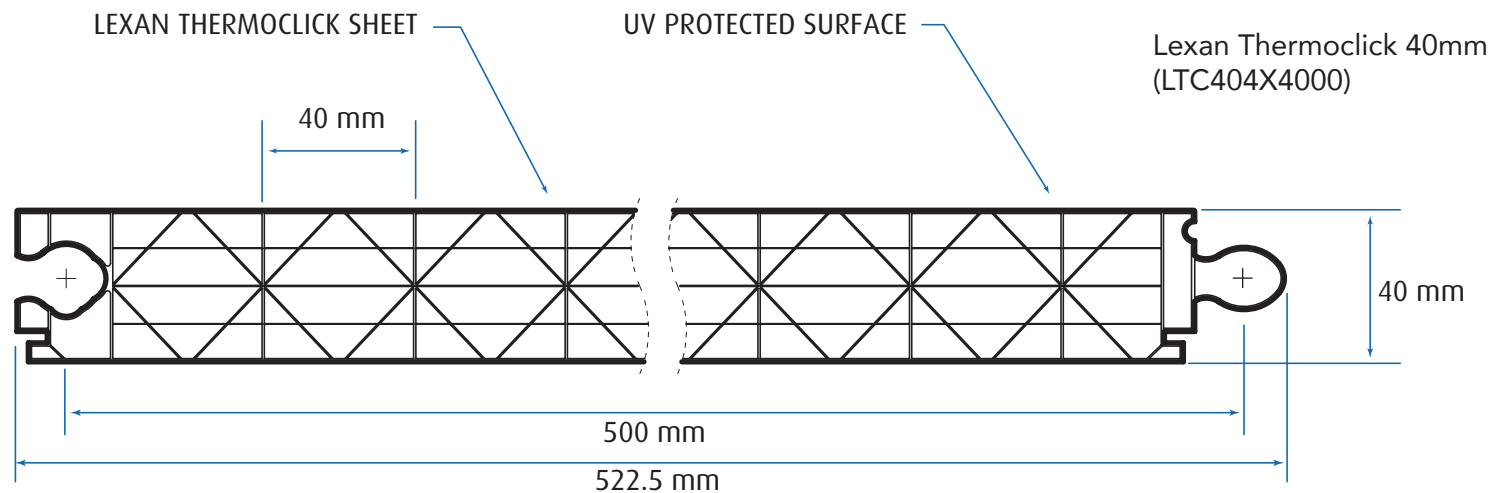

Accessories

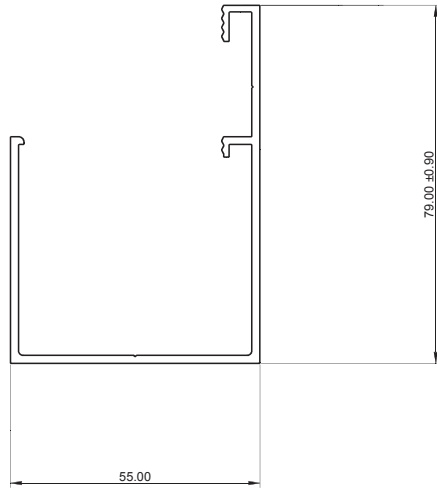

THERMOCLICK – HEAD AND
SIDE CHANNEL

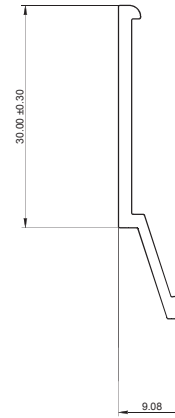

THERMOCLICK SILL
COVER

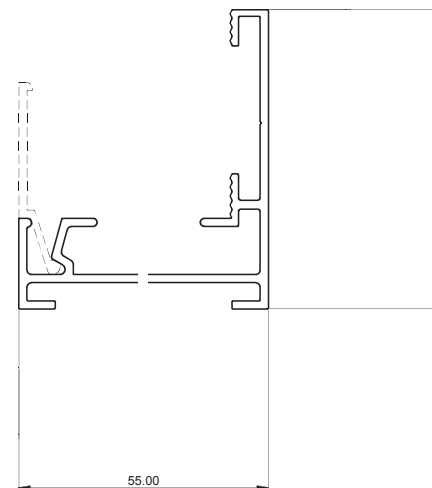

THERMOCLICK – SILL
CHANNEL

Accessories

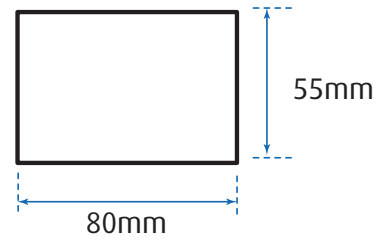

THERMOCLICK CHANNEL JOINER PLATE -
Connected with riverts or small screws

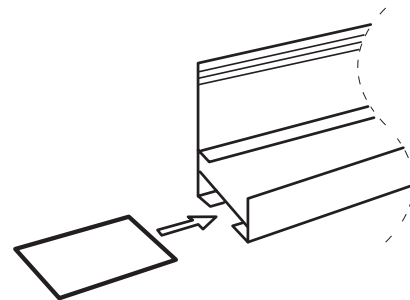

THERMOCLICK SILL CHANNEL

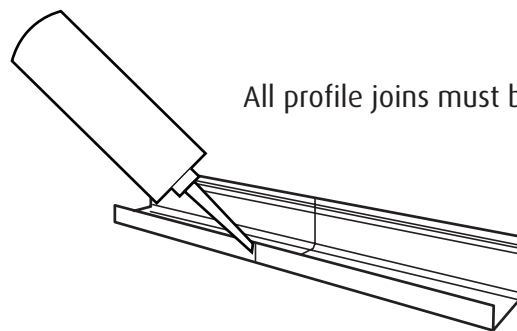

All profile joins must be sealed with silicone

THERMOCLICK HEAD AND SIDE CHANNEL

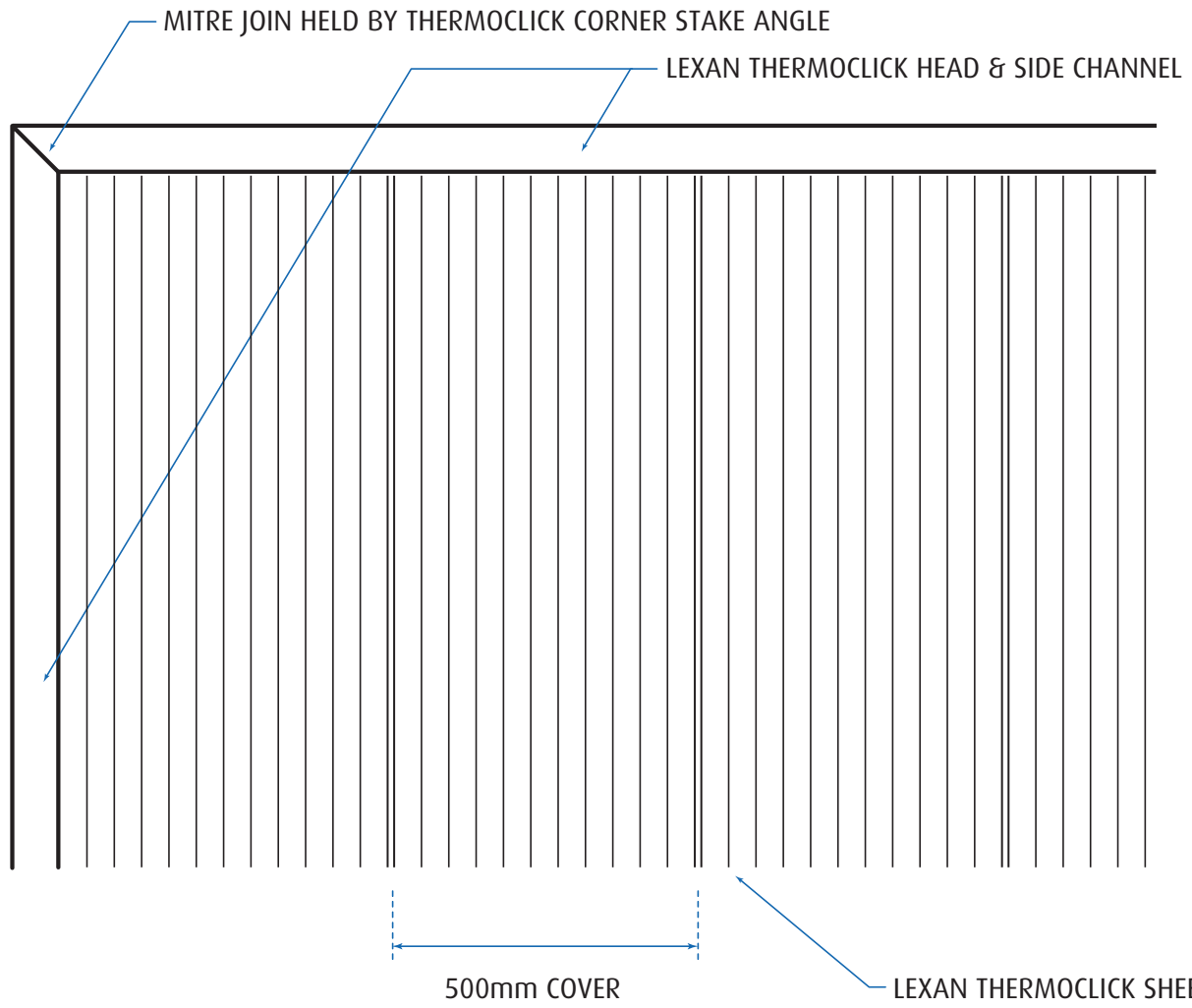

The Thermoclick Corner Stake Angle is connected with rivets or small screws.

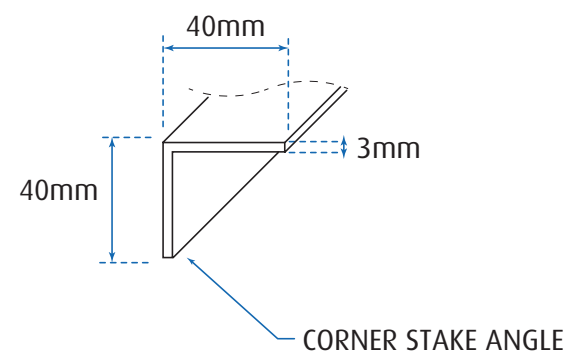

Channel Corner Detail Thermoclick Profile

March 2015

DRAWN - MM

© Ampelite 2015

Accessories



Thermoclick – Sealer Tape

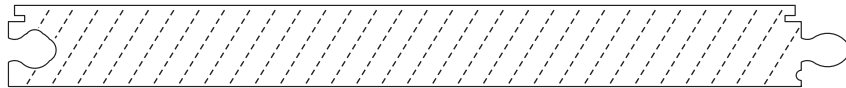

Thermoclick – Breather Tape

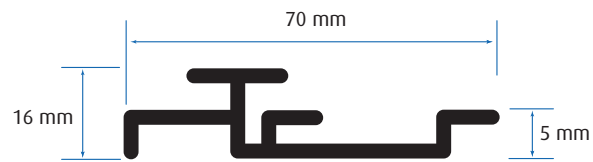

Thermoclick – Face Fix Key Bracket

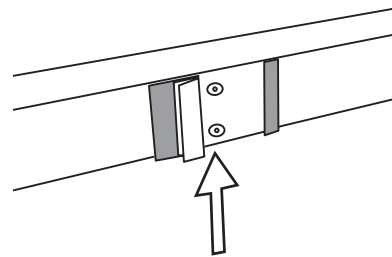

The Thermoclick – Face fix key bracket must be fixed with at least two screws to the purlin.

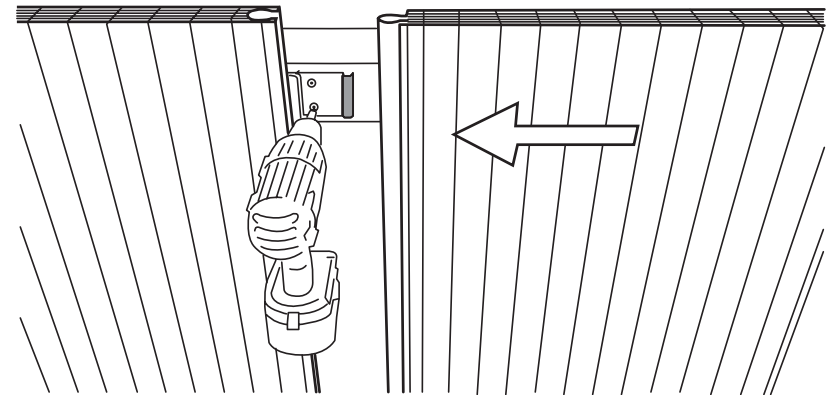

The Thermoclick – Face fix key bracket must be positioned on the purlin and be pushed against the panel and located in the groove.

OUTSIDE OR
EXTERNAL FACE

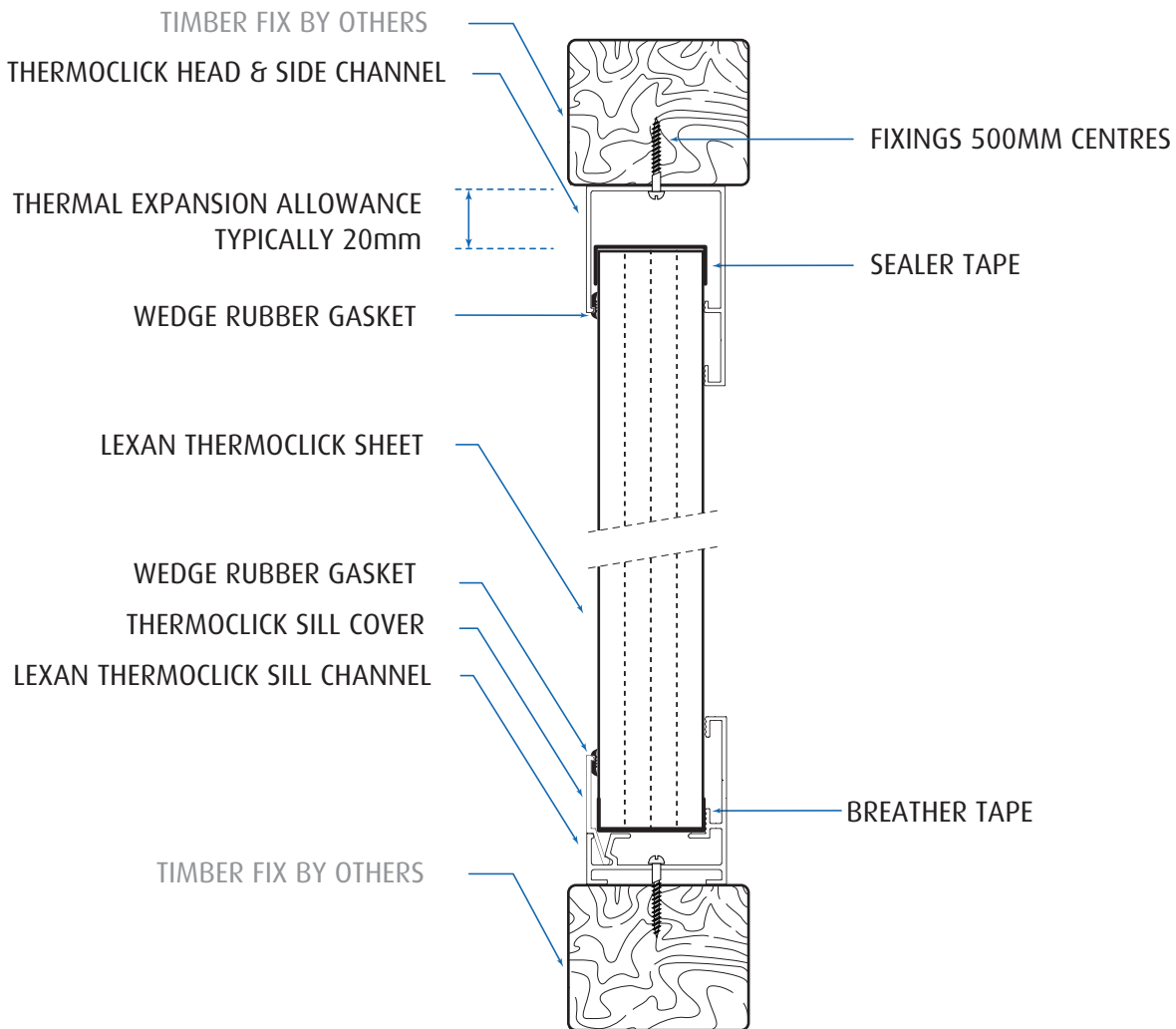

Typical glazing Detail – 1 Thermoclick Profile

March 2015

DRAWN - MM

© Ampelite 2015

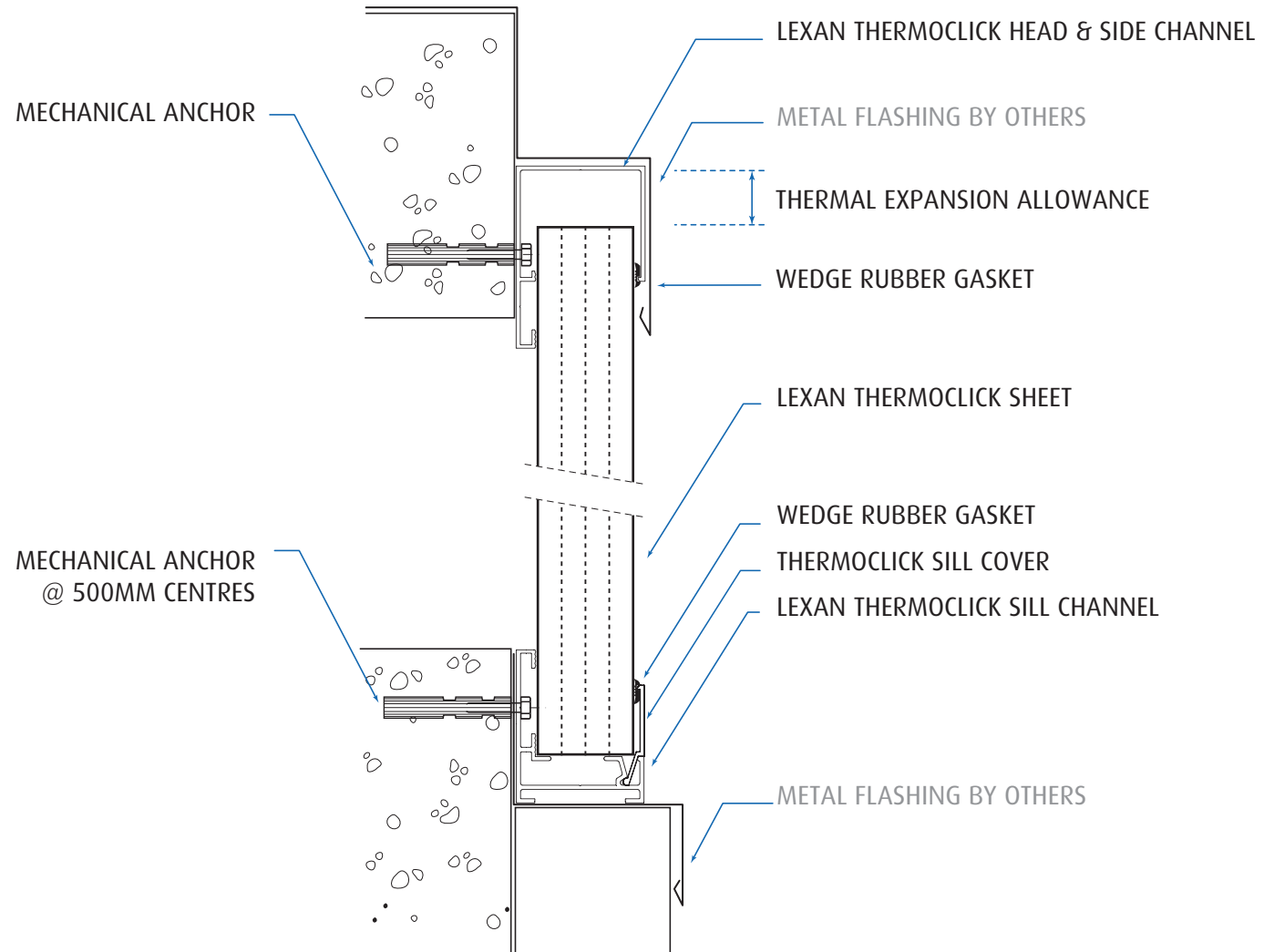

Typical glazing Detail – 2 Thermoclick Profile

March 2015

DRAWN - MM

© Ampelite 2015

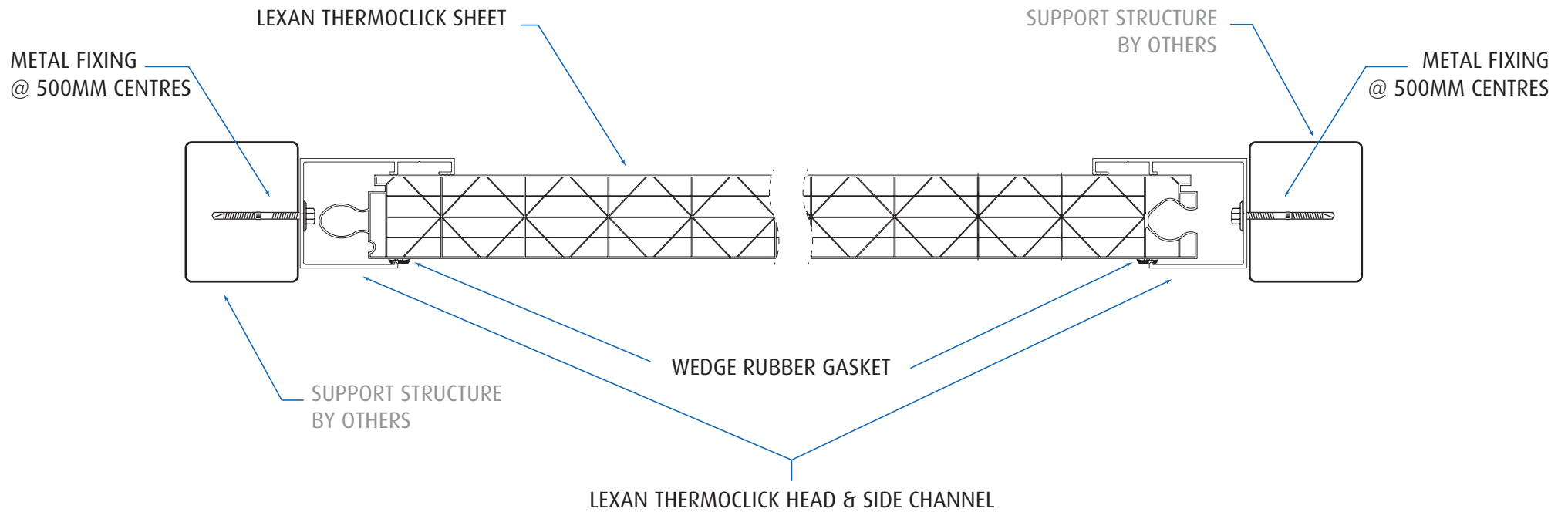

Typical glazing Detail – 3 Thermoclick Profile

March 2015

DRAWN - MM

© Ampelite 2015

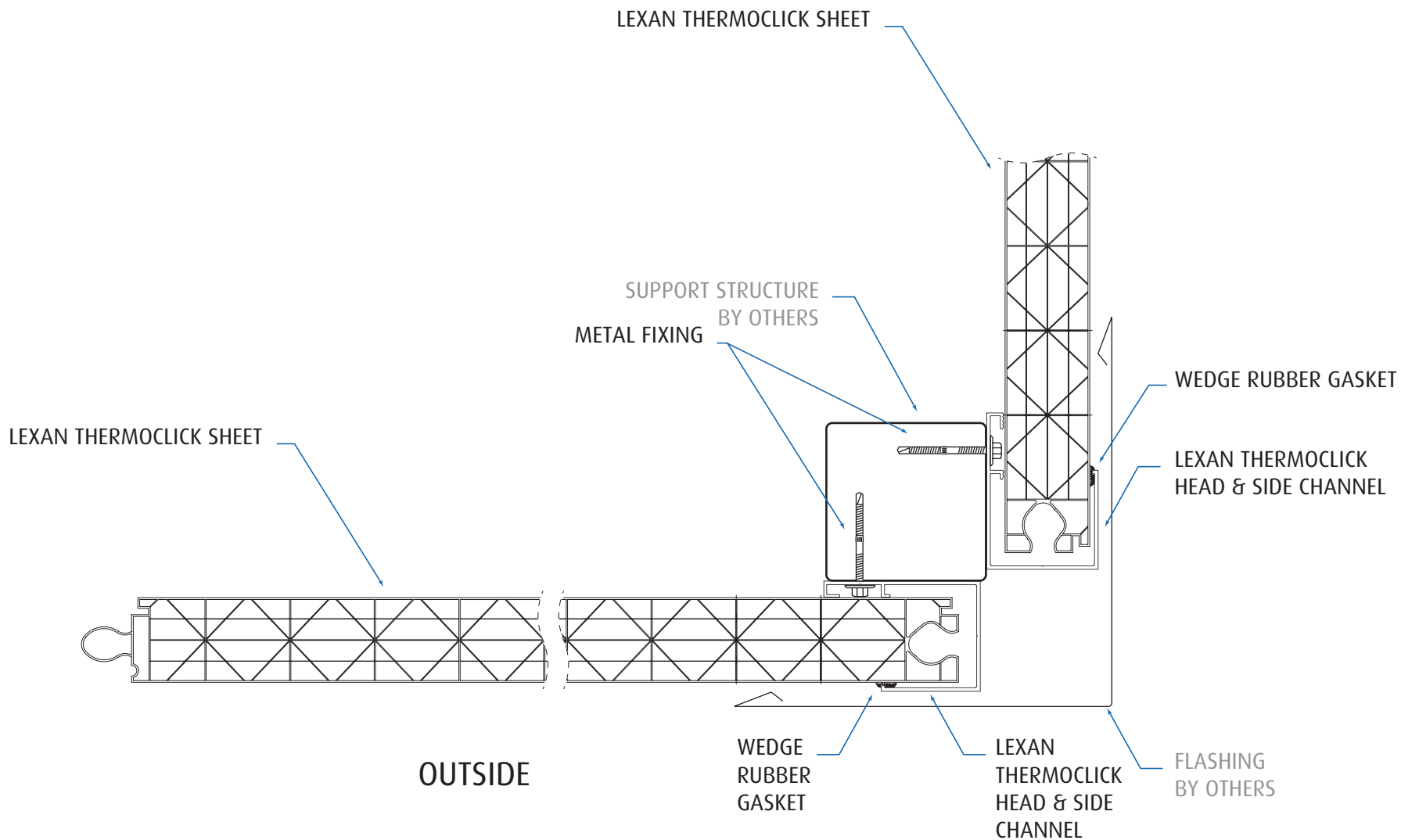

External Corner Detail – 1 ThermoClick Profile

March 2015

DRAWN - MM

© Ampelite 2015

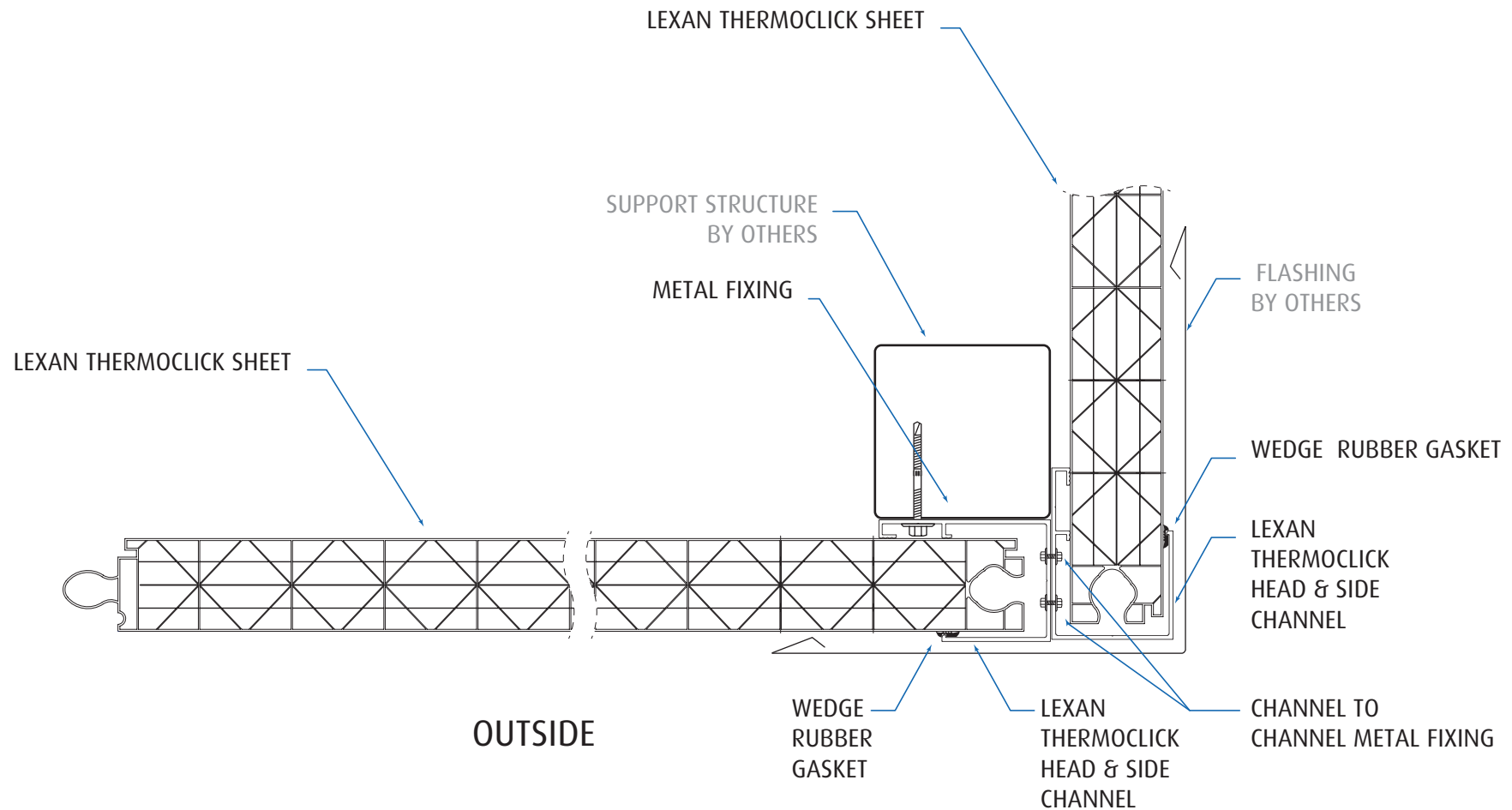

External Corner Detail - 2 Thermoclick Profile

March 2015

DRAWN - MM

© Ampelite 2015

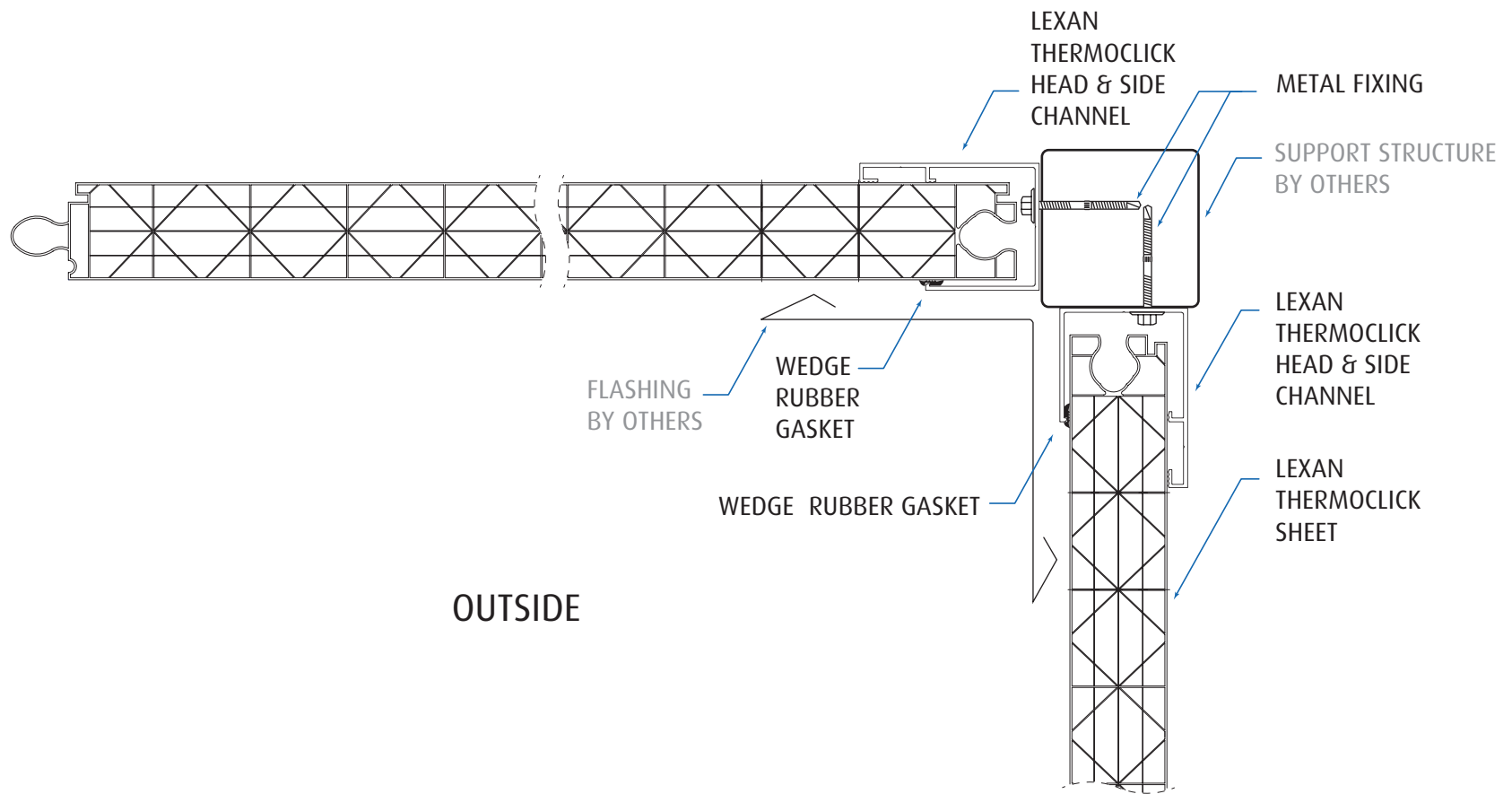

Internal Corner Detail – 1 Thermoclick Profile

MARCH 2015

DRAWN - MM

© Ampelite 2015

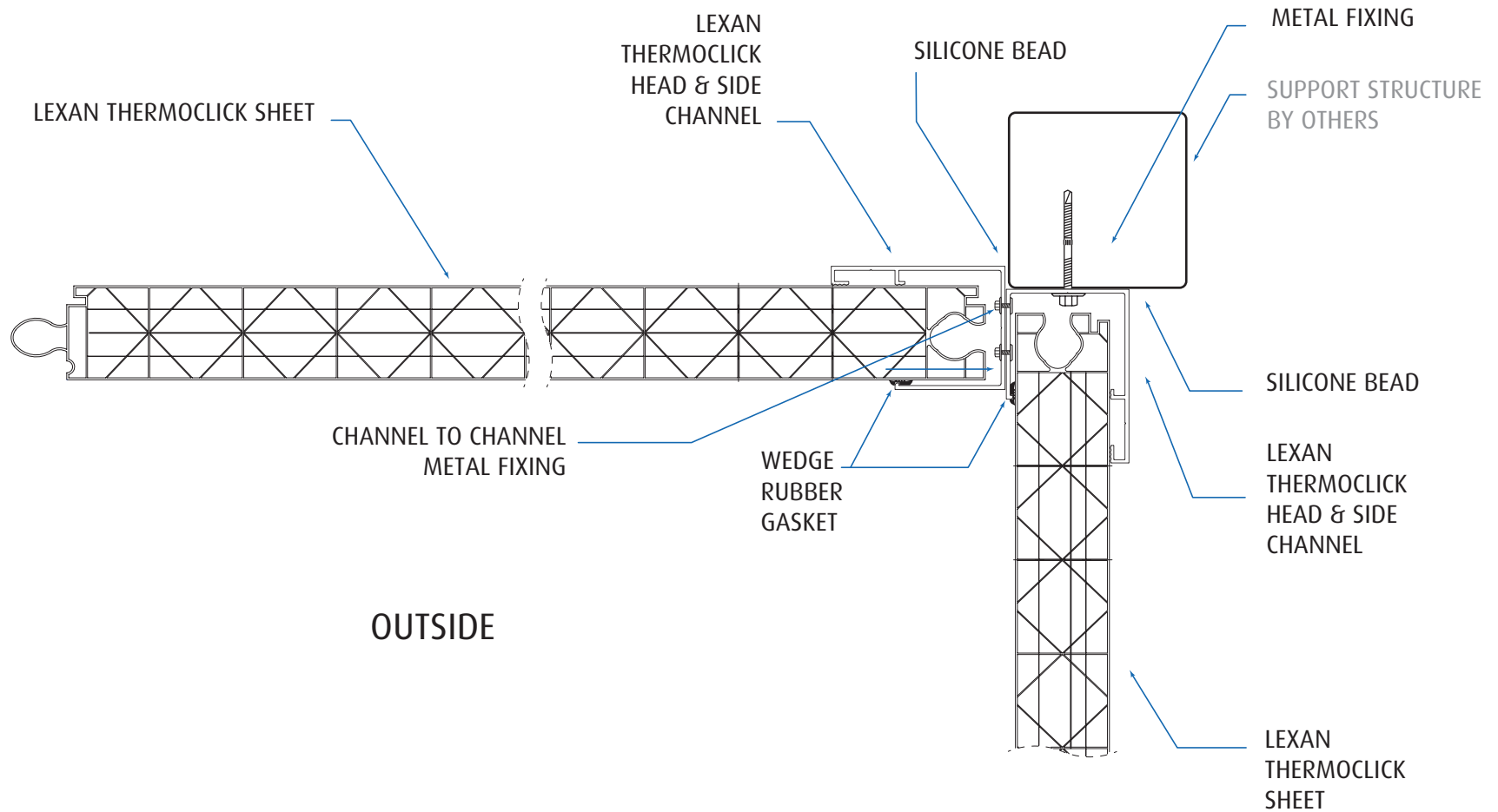

Internal Corner Detail – 2 Thermoclick Profile

MARCH 2015

DRAWN - MM

© Ampelite 2015

